

site 4

connect

verb bring together or into contact so that a real or notional link is established

The Aurelian Walls once stood as an obstacle keeping unwelcome guests from entering Rome. Today, the walls stand as an obstacle for the citizens of Rome, preventing access to public and private spaces on the other side. As a means of connectivity, this project looks to unplug slits in the wall's facade. By unplugging and extending these openings citizens are able to pass through the wall and enter a public park. The new opening will be angled so that the wall's elevation appears solid except for a series tall slender slits based on the existing condition of the wall. From the street these openings will give a hint to what is beyond on the wall.



site 5
elevate





site 5
elevate

verb to move or raise to a higher place or position; lift up

The concept of creating pedestrian circulation by ramping up to allow passage over the wall, unifying two separate environments on opposite sides of the wall. Both areas bringing a different feeling to the overall nature of the site. One side being an open natural environment, while the other side conforming to a tight urban environment. By ramping up between two towers of the wall one will be able to move from one side to the other, in doing so they will be interacting with the wall. An existing tower will house an elevator allowing one to move from an elevated portion atop the wall back down to street level.



site 6
sequence

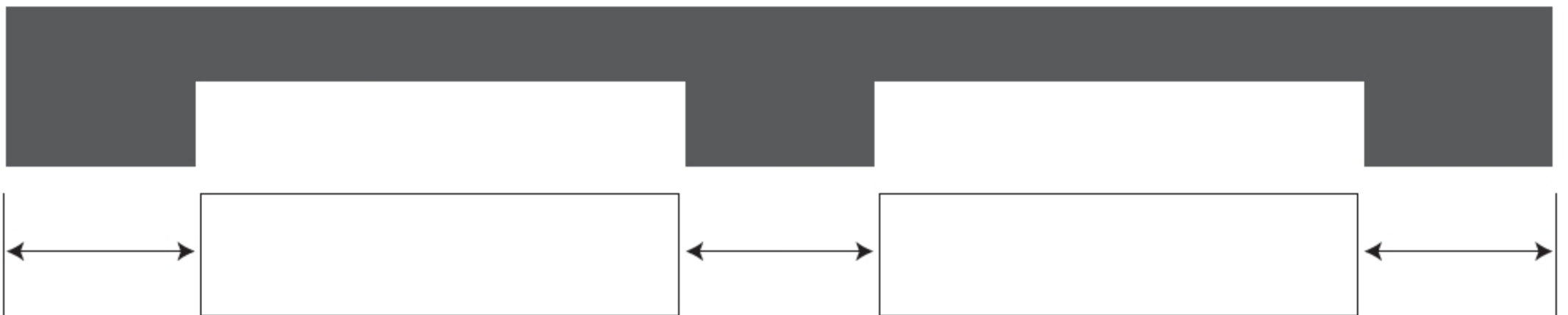



site 6

sequence

noun

1. The following of one another; succession.
2. Order of succession.
3. A continuous or connected series.
4. Something that follows; a subsequent event; result; consequence.

The wall contains towers along its stretch. These towers jut out from the main mass of the wall, creating moments of compression, while also working to define pockets of space between them. These moments created by the towers allow for places of stasis and the movement between these destinations.

“Stasis” becomes moments for activity, space, and program.

“Movement” is the travel between them.

The sequence brings order to the site as a whole. The current park along the wall is unkept and hardly used, but the sequence can begin to animate the park and allow for life to happen along the wall.

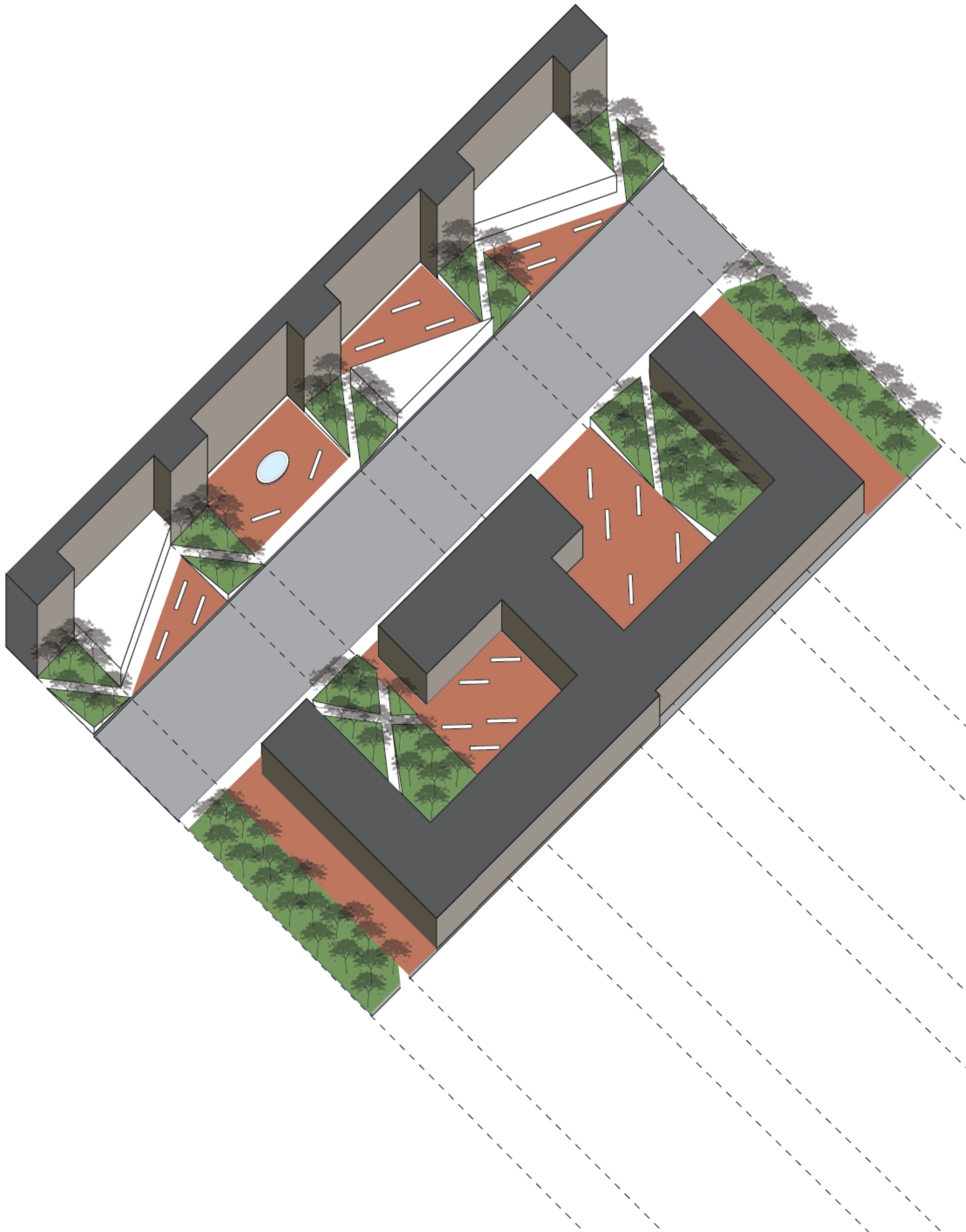

site 7
climbing





site 7
climbing

Wall climbing is an exercise that takes places on a wall surface with grips.

In ancient time, enemies climbed on the wall in order to invade the city. However, nowadays wall climbing became an activity as well as exercise for climbers to challenge their balance and other skills.

The brick tower along with Aurelian walls defines a vertical volume. It could be considered as a tree or ladder that leads you up to top of the wall and sky. This structural skin serves as part of the Aurelian wall. The climbing wall is constructed with concrete slabs on the outside. In addition, the grips on the wall for climbers are made out of Roman streets material- San Pietrini. Tracking from Piazzale Metronio to Porta San. Sebastiano, the soccer field, tennis court and the linear park define a series of activities as well as spaces. The climbing wall is one of the potential outdoor activities that could engage individuals to the wall.



site 8
intersect





site 8
intersect

verb to cut or divide by passing through or across

The section marked in red is the possibility for a transition space to provide continuous movement along side the wall. The movement would be from the south side of the wall, currently blocked off by the private tennis courts, to the north side.

Acting as a threshold, different types of intersecting planes would allow for movement from one side of the city to the other currently blocked by the wall. This space would also allow for people to move inside the wall or beside it.

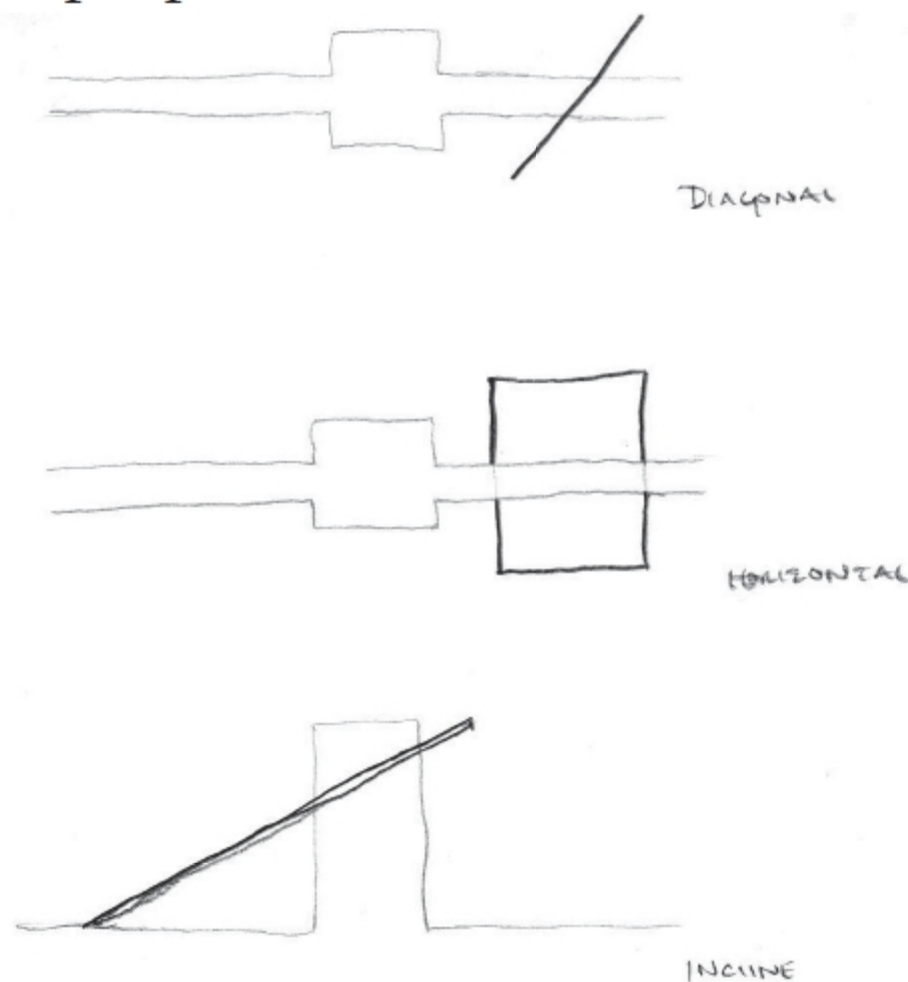



site 9
descent

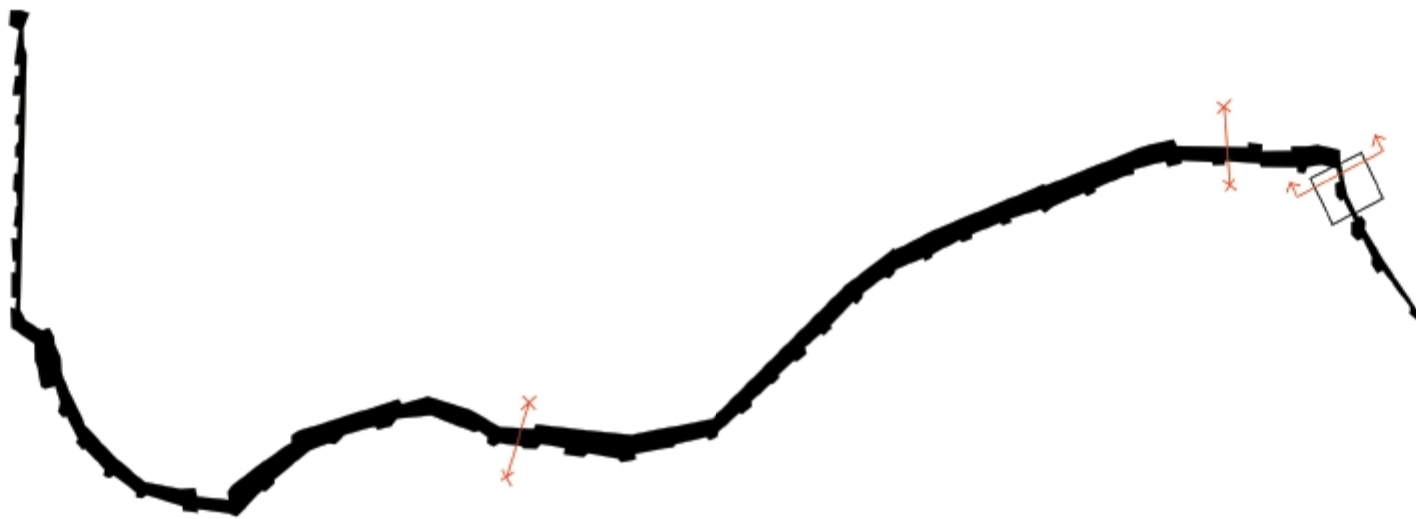



site 9

descent

Noun

the act, process, or fact of moving from a higher to a lower position.

The concept of creating circulation that utilizes a passage below the wall, uniting reflexive spaces and environments on opposite sides of the wall. These spaces are of a combating nature in that one side is an open natural environment, while the opposing side is a tight urban space. The tight, sudden descent from the urban side will inconspicuously direct the pedestrian to the openness of a natural space on the adjacent side once below the wall.

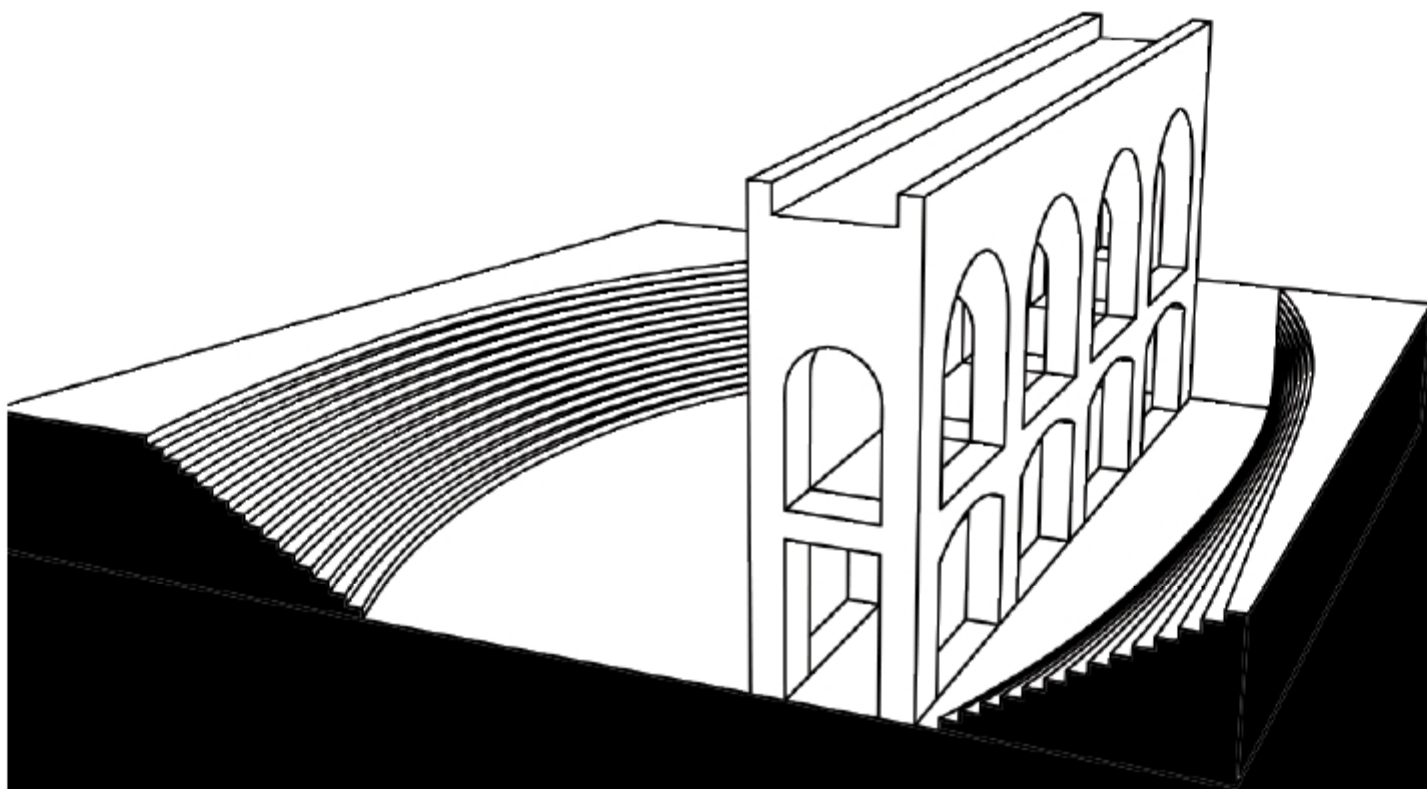

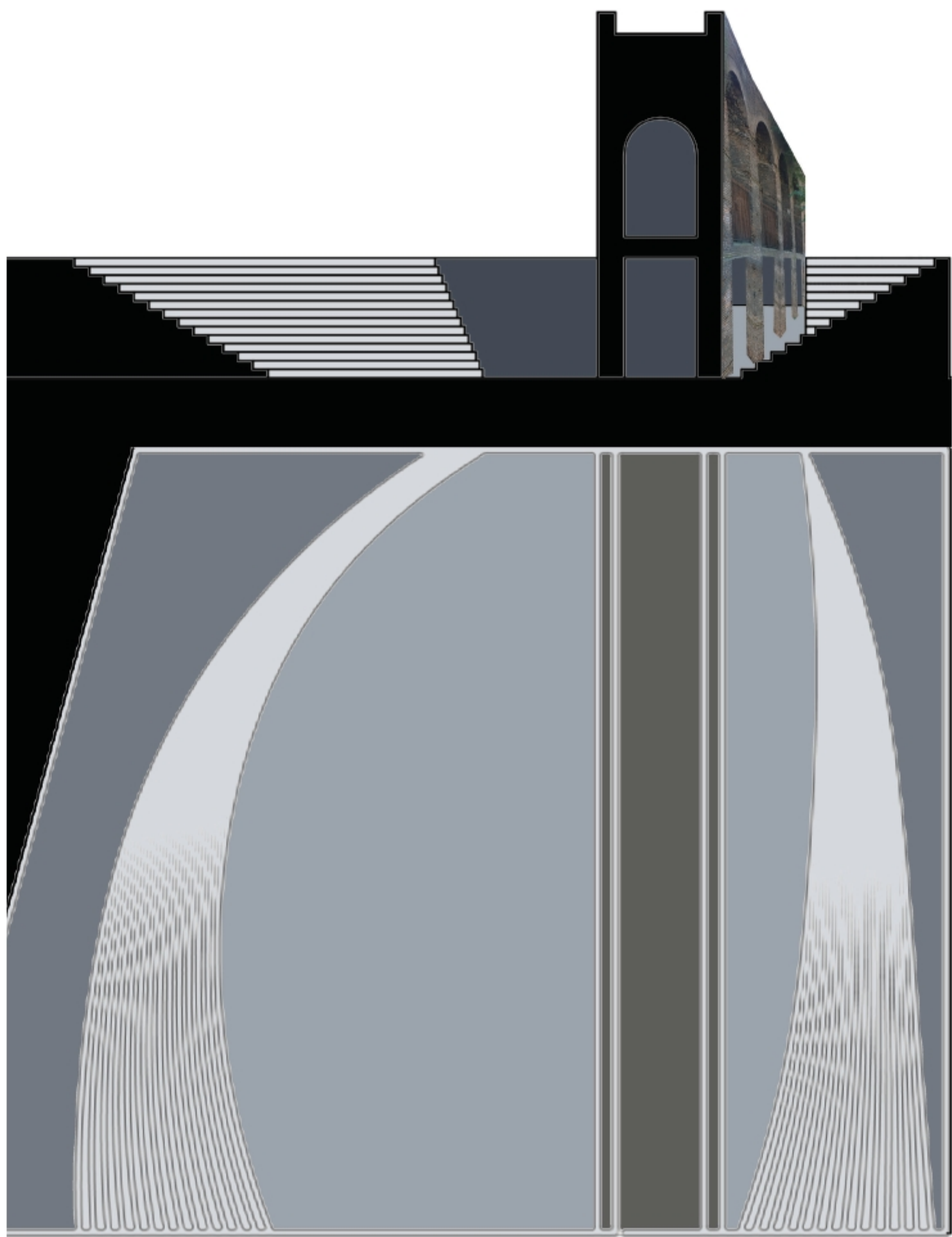

site 10
isolation





site 10

isolation

noun

1. to set or place apart; detach or separate so as to be alone.
2. Medicine/Medical. to keep (an infected person) from contact with noninfected persons; quarantine.
3. Chemistry, Bacteriology. to obtain (a substance or microorganism) in an uncombined or pure state.
4. a person, thing, or group that is set apart or isolated, as for purposes of study.
5. Psychology. a person, often shy or lacking in social skills, who avoids the company of others and has no friends within a group.
6. isolated; alone.

The concept of creating isolated spaces in which people could appreciate the wall architecture without being involved in the noisy of the city.



International Design Workshop

Roma 3.0 Wall Walk

Architect Luca Galofaro

Architect Benedetta Pelusio

site 1

transcend Spencer Zimmerman

site 2

contamination Alexandru Dumitru Musteata

site 3

balance Iyppi Ryan

site 4

connect Jaclyn Hagen

site 5

elevate Drew Talarick

site 6

sequence Shane Maloney

site 7

climbing Shenting Wang

site 8

intersect Juan Martinez

site 9

descent Cortland Shankweiler

site 10

isolation Arianna Raneri